



SEALFAST
THE SIMPLE SOLUTION

PIPE FITTINGS & VALVES



STEEL

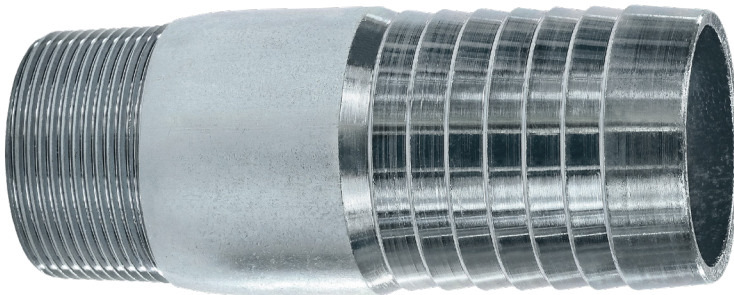

ZINC PLATES STEEL

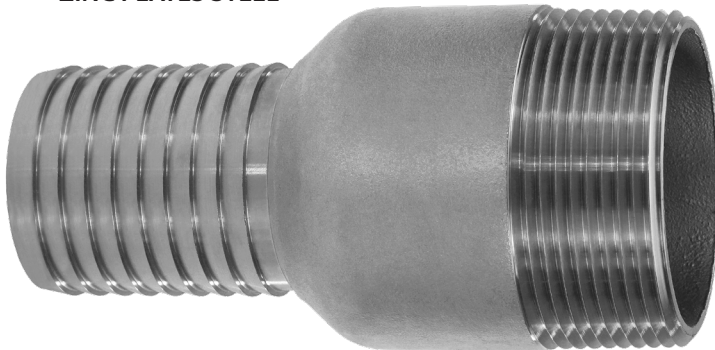

304 SS

COMBINATION NIPPLES

MALE NPT - REDUCING / INCREASING
STEEL, ZINC PLATED & SS 304

FEATURES & APPLICATIONS:

• General Uses:

Working pressures may vary with type and clamping system used to install couplings.

Combination Nipples are recommended for low pressure discharge and suction service for compatible liquids. NOT for compressible products such as Air, Nitrogen and Steam.

*All blank end & grooved combination nipples are made using Schedule 40 pipe.

Seal Fast Crimp Combination Nipples are to be used with Seal Fast Ferrules and Crimp Sleeves. They are designed with an Interlock System which allows the Ferrule to be permanently attached to the coupling.

WORKING PRESSURE 200 PSI

STEEL, ZINC PLATED & STAINLESS 304

| SIZE | STEEL # | ZINC PLATED # | 304 SS # |
|-----------------|-----------|---------------|------------|
| 3/4" x 1/2" | SF075050S | SF075050SP | SF075050SS |
| 3/4" x 1" | SF075100S | SF075100SP | SF075100SS |
| 1" x 3/4" | SF100075S | SF100075SP | SF100075SS |
| 1" x 1-1/4" | SF100125S | SF100125SP | SF100125SS |
| 1-1/4" x 1" | SF125100S | SF125100SP | SF125100SS |
| 1-1/4" x 1-1/2" | SF125150S | SF125150SP | SF125150SS |
| 1-1/2" x 1" | SF150100S | SF150100SP | SF150100SS |
| 1-1/2" x 1-1/4" | SF150125S | SF150125SP | SF150125SS |
| 1-1/2" x 2" | SF150200S | SF150200SP | SF150200SS |
| 2" x 1-1/2" | SF200150S | SF200150SP | SF200150SS |
| 2" x 2-1/2" | SF200250S | SF200250SP | SF200250SS |
| 2" x 3" | SF200300S | SF200300SP | SF200300SS |
| 2-1/2" x 2" | SF250200S | SF250200SP | SF250200SS |
| 3" x 2" | SF300200S | SF300200SP | SF300200SS |



Information contained on this page is for general information purposes only. Seal Fast Inc. assumes no responsibility for errors or omissions for this product.



SEALFAST
THE SIMPLE SOLUTION

PIPE FITTINGS & VALVES

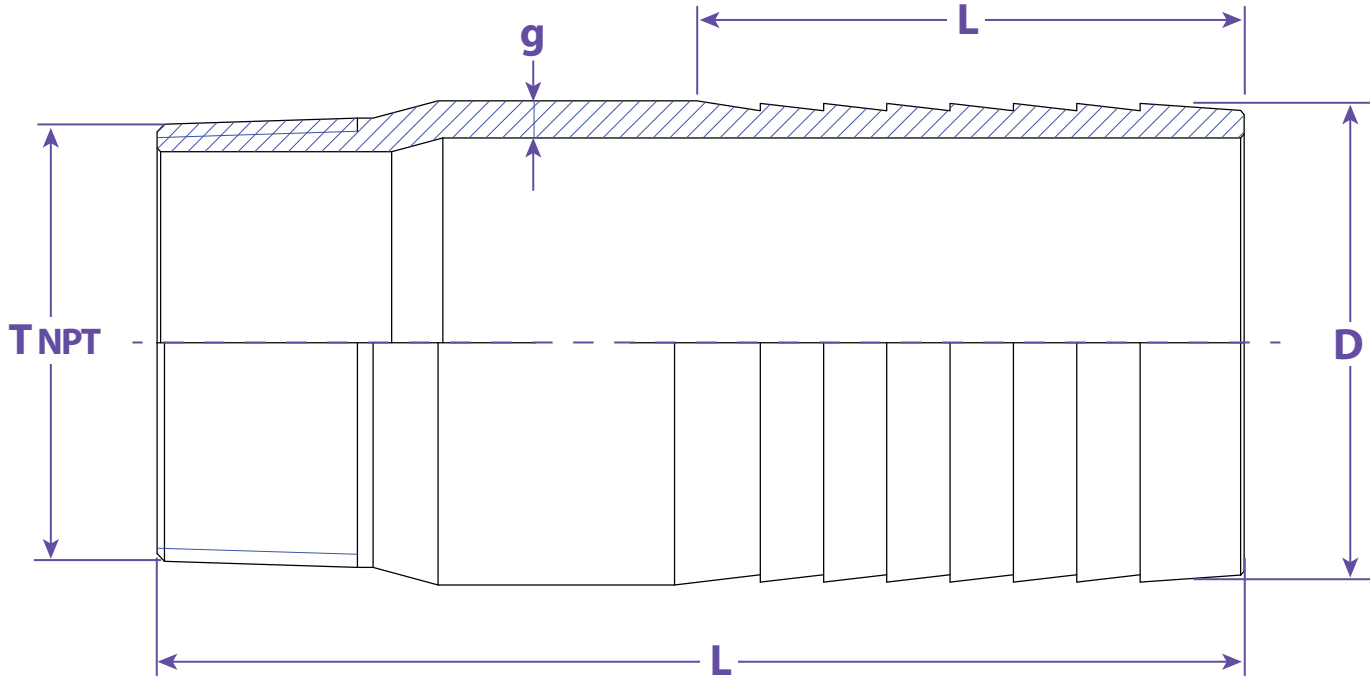

Dimensions

| D & T | L | Ls | g | T | Part # |
|-----------------|--------|--------|--------|--------|-----------|
| 3/4" x 1/2" | 3.0118 | 1.5748 | 0.0906 | 1/2" | SF075050x |
| 3/4" x 1" | --- | --- | --- | --- | SF075100x |
| 1" x 3/4" | 3.0118 | 1.6142 | 0.0906 | 3/4" | SF100075x |
| 1" x 1-1/4" | --- | --- | --- | --- | SF100125x |
| 1-1/4" x 1" | 3.6614 | 1.8504 | 0.1260 | 1" | SF125100x |
| 1-1/4" x 1-1/2" | --- | --- | --- | --- | SF125150x |
| 1-1/2" x 1" | 4.0551 | 2.1260 | 0.1260 | 1" | SF150100x |
| 1-1/2" x 1-1/4" | 4.0551 | 2.1260 | 0.1260 | 1-1/4" | SF150125x |
| 1-1/2" x 2" | --- | --- | --- | --- | SF150200x |
| 2" x 1-1/2" | 5.000 | 2.4803 | 0.1260 | 1-1/2" | SF200150x |
| 2" x 2-1/2" | --- | --- | --- | --- | SF200250x |
| 2" x 3" | --- | --- | --- | --- | SF200300x |
| 2-1/2" x 2" | 5.7480 | 2.9528 | 0.1575 | 2" | SF250200x |
| 3" x 2" | 5.7480 | 3.3858 | 0.1575 | 2" | SF300200x |

TITLE COMBINATION NIPPLES - HOSE X MALE NPT STEEL

DISCLAIMER

All drawings and specifications are subject to change without notice. Drawings represent general dimensions of our products. Seal Fast cannot guarantee the dimensions of the part will exactly match those in the drawing. This drawing is the property of Seal Fast Inc. Copying or reproduction of this drawing is expressly prohibited.

MATERIAL

SFxxxS Carbon Steel Tube
SFxxxSP Zinc Plated Steel
SFxxxSS Stainless Steel Tube 304

DRAWING NOT TO SCALE

PART # SF...S, SP, SS



SEALFAST
THE SIMPLE SOLUTION